

# SPHINX GARDEN

2001-2001, Amsterdam, The Netherlands

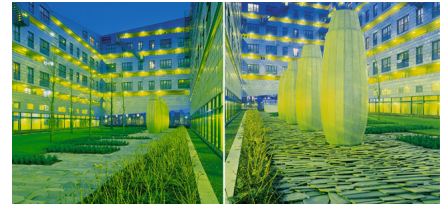

The sphinx block of the West 8 designed Borneo Sporenburg, with its semi-public courtyard, seemed to be the perfect condition for a poetic garden design. West 8 designed this green space as a natural still life, with the building's zinc façades inspiring the design of four custom freestanding vases constructed of zinc as well. These eloquent hand-made vases are positioned in a surface of Norwegian slate, reflecting the silver-grey fish-skin zinc facades. The courtyard continues its march with plantings of grass, blue vegetation, Hydrangeas, and shaped hedges. Eight large Ginkgo trees contrast with their surreal botanic structuralism against the zinc facades, and fences made of steel plates with a graphic pattern of Ginkgo leaves.

## client

City of Amsterdam

## team

Adriaan Geuze, Freek Boerwinkel